

PARTS LIST AND INSTRUCTIONS

DIGI-MATIC DIAMOND BLADE AND CORE BIT GAUGE



A Division of Equipment Development Company, Inc.

100 Thomas Johnson Drive, Frederick, MD 21702-4600 USA
Phone (301) 663-1600 • 1-800-638-3326
Fax (301) 663-1607 • 1-800-447-3326
Website: www.edcoinc.com
Email: sales@edcoinc.com

Printed in USA

JWA ©2012

ILLUSTRATION FOR DIGI-MATIC GAUGES

DIAMOND BLADE GAUGE

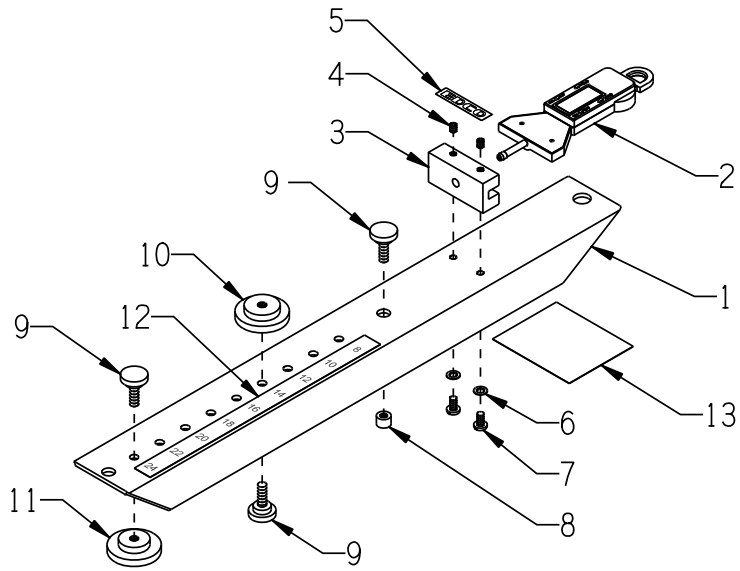

DIAMOND BLADE & CORE BIT GAUGE

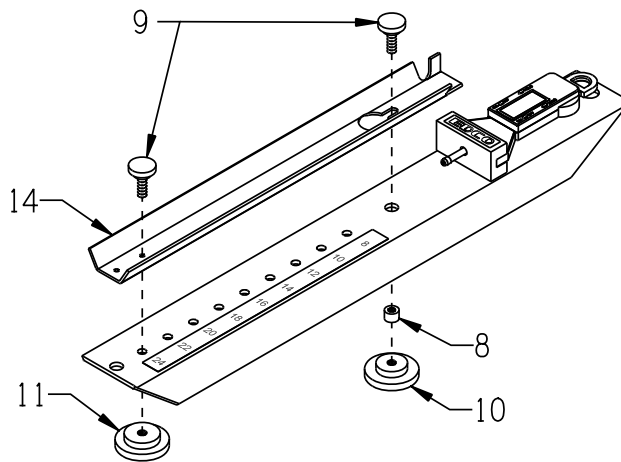

RING-BLADE GAUGE

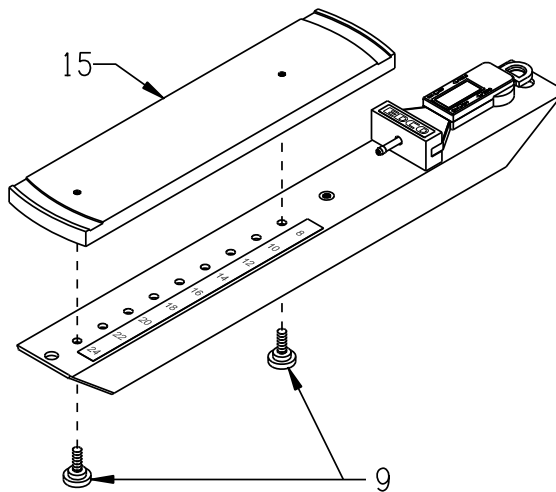

DIGI-MATIC BLADE GAUGES (INCLUDES ITEMS 1 THRU 13)	
PART #	DESCRIPTION
30007	DIGIMATIC BLADE GAUGE 24" (SHOWN)
30016	DIGIMATIC BLADE GAUGE 36"
30025	DIGIMATIC BLADE GAUGE, 600MM METRIC
30028	DIGIMATIC BLADE GAUGE, 900MM METRIC

DIGI-MATIC BLADE & CORE BIT GAUGES (INCLUDES ITEMS 1 THRU 14)	
PART #	DESCRIPTION
30008	DIGIMATIC BLADE/CORE BIT GAUGE 24" (SHOWN)
30017	DIGIMATIC BLADE/CORE BIT GAUGE 36"
30026	DIGIMATIC BLADE/CORE BIT GAUGE 600MM METRIC

PARTS LISTING FOR DIGI-MATIC GAUGES			
ITEM #	PART #	DESCRIPTION	QTY.
1	30009	FRAME, "DIGI-MATIC" GAUGE, 24	1
	30036	FRAME, "DIGI-MATIC" GAUGE, 36	1
2	30030	MICROMETER HEAD, FOWLER INCH/METRIC/FRACTION INCLUDES: CR2032 BATTERY	1
3	30031	MOUNT BLOCK, FOWLER GAUGE	1
4	10371	SCREW, SET 10-32 X 1/4	2
5	91330	DECAL, EDCO (HORZ.) 7/16 X 1-13/16	1
6	10831	WASHER, LOCK, INT. TOOTH #10	2
7	10830	SCREW, MACHINE SHWH 10-32 X 1/2	2
8	10439	THREAD-SERT 1/4-20, BLIND RIVET (REQUIRES SPECIAL TOOL TO INSTALL)	1
9	30014	SCREW, KNURLED THUMB 1/4-20 X 3/4	3
10	30002	ADAPTER, BLADE GAUGE, 1"-20MM ARBOR	1
11	30003	ADAPTER, BLADE GAUGE, 7/8-5/8"ARBOR	1
12	91120	DECAL, DIGI-MATIC NUMBER STRIP 8-24"	1
	91135	DECAL, DIGI-MATIC NUMBER STRIP 8-36"	1
	91121	DECAL, DIGI-MATIC NUM STRIP 200-600 mm	1
	91138	DECAL, DIGI-MATIC NUM STRIP 200-900 mm	1
13	91134	DECAL, INSTRUCTIONS FOR DIGI-MATIC	1
14	30024	ADAPTER BRKT., CORE BIT, DIGI-MATIC	1
15	30027	ADAPTER, 14" RING BLADE (OPTIONAL)	1



PHOTO COPY THIS PAGE FOR BLADE WEAR RECORDS

INSTRUCTIONS FOR USING

EDCO's DIGI-MATIC™ BLADE GAUGE

- 1** Attach arbor hub at proper blade size position.
- 2** Turn gauge "ON" and press "ZERO" button. Display should read (0.000). Be sure the inch ("IN") setting appears in the display window. Press function button to change ("IN") setting.
- 3** Retract and hold plunger while positioning blade on hub and seat firmly.
- 4** Allow plunger to contact blade segment.
- 5** Note reading and enter figures at "START".

START _____

END - _____

- 6** AMOUNT/WEAR _____

- 7** To determine blade wear-
Repeat items #1 thru #5, enter new readings at "END".
Subtract "END" value from "START" value to determine amount of wear.

Compute Charges:

#6 x charge per .001 inch plus minimum (if any).

TURN GAUGE "OFF" WHEN NOT IN USE

NOTES: